

LOAD FOOT M12

Self-centering load feet
rigid
Rubber base

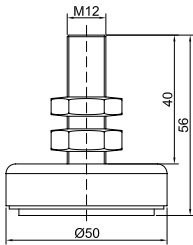

Reference	Metric	Material	Weight transport (kg)	#Code
-	M12	Zinc plated	0,090	510083



LOAD FOOT M12

Self-centering load feet
Stainless steel
Base in hard plastic.



Reference	Metric	Material	Weight transport (kg)	#Code
-	M12	Stainless steel	0,120	510084

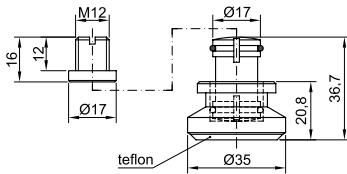

LOAD FOOT M20

Self-centering load feet of sliding cylinder.
Small height.
Stainless steel
Teflon base.
Includes accessory for height adjustment.



Reference	Metric	Material	Weight transport (kg)	#Code
-	M20	Nickel plated	0,120	510088

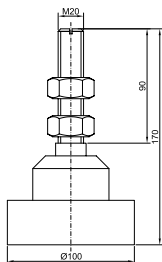

LOAD FOOT M20

Self-centering load foot
with ball.
Up to 10 t



Reference	Metric	Material	Weight transport (kg)	#Code
-	M20	Nickel plated	2,6	510086
-	M20	Stainless steel	2,6	510087